

## PowerSeeker 76AZ



Item# 21044



Questions or Problems with Set-up?

CONTACT:

Celestron Technical Support: 310.803.5955

## Quick Set-up Guide



Your PowerSeeker 76AZ includes: optical tube with two threaded mounting bolts; tripod with center support bracket; two eyepieces; a 3x barlow lens, finderscope; slow motion control rod; eyepiece accessory tray; The Sky® CD software; owner's manual.



To set up the tripod, spread the legs outward until they are fully extended and push down center locking brace.

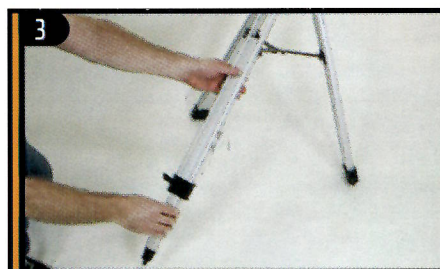

Extend the center portion of each of the three tripod legs down 6-12". Use the three tightening screws located at the bottom of each leg to secure the extended legs in place.



All three legs should be the same length to provide a level platform for the telescope.

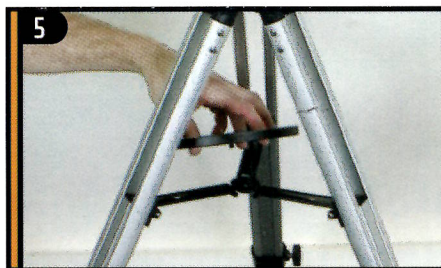

Place the accessory tray on top of tripod's center leg brace. Thread the tray into the threaded hole in the center of the leg brace.

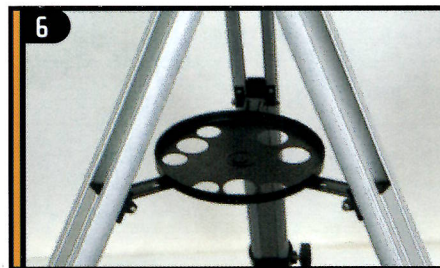

Properly assembled, the accessory tray should appear as pictured above.



Locate the optical tube and line up the tube with the holes on the mount.



Secure the tube to the mount using the two threaded mounting bolts. Tighten to secure in place.

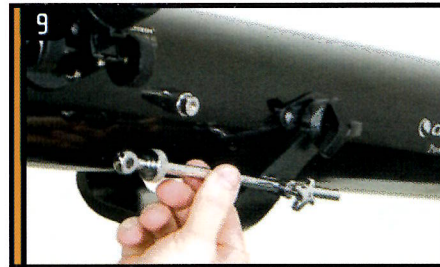

Insert the slow motion control rod into the hole on the mount.



## Quick Set-up Guide [cont]



Secure slow motion control rod to telescope tube by attaching the included bolt and tightening.



Locate the finderscope. Remove the knurled nuts on the threaded posts at the focuser end of the telescope tube.



Orient the finderscope so that the lens window is facing towards the front of the tube. Place finderscope over the posts on the tube and replace knurled nuts.



Loosen the set screws on the focuser so that they do not obstruct the inner diameter of the focuser. Remove the plastic cap covering the end of the focuser.



Insert the barrel of the 20mm eyepiece into the focuser and tighten the set screws.



Remove the lens cap from the front of the telescope. To observe, look through the eyepiece as shown above.

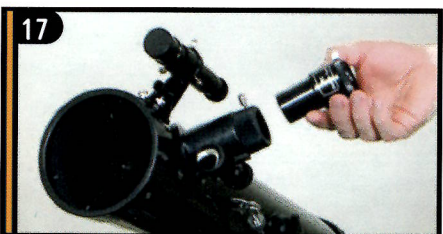

For additional magnification, you can use the included 3x barlow. Place the barlow in the focuser in place of the eyepiece and tighten set screw — remove the cap from the barlow.

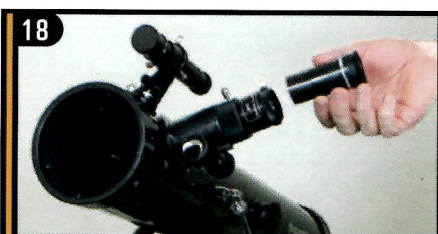

Insert the chrome barrel of the 20mm eyepiece into the barlow and tighten the set screw to secure in place.

**For detailed usage information please consult your owner's manual.**