

DRAGON

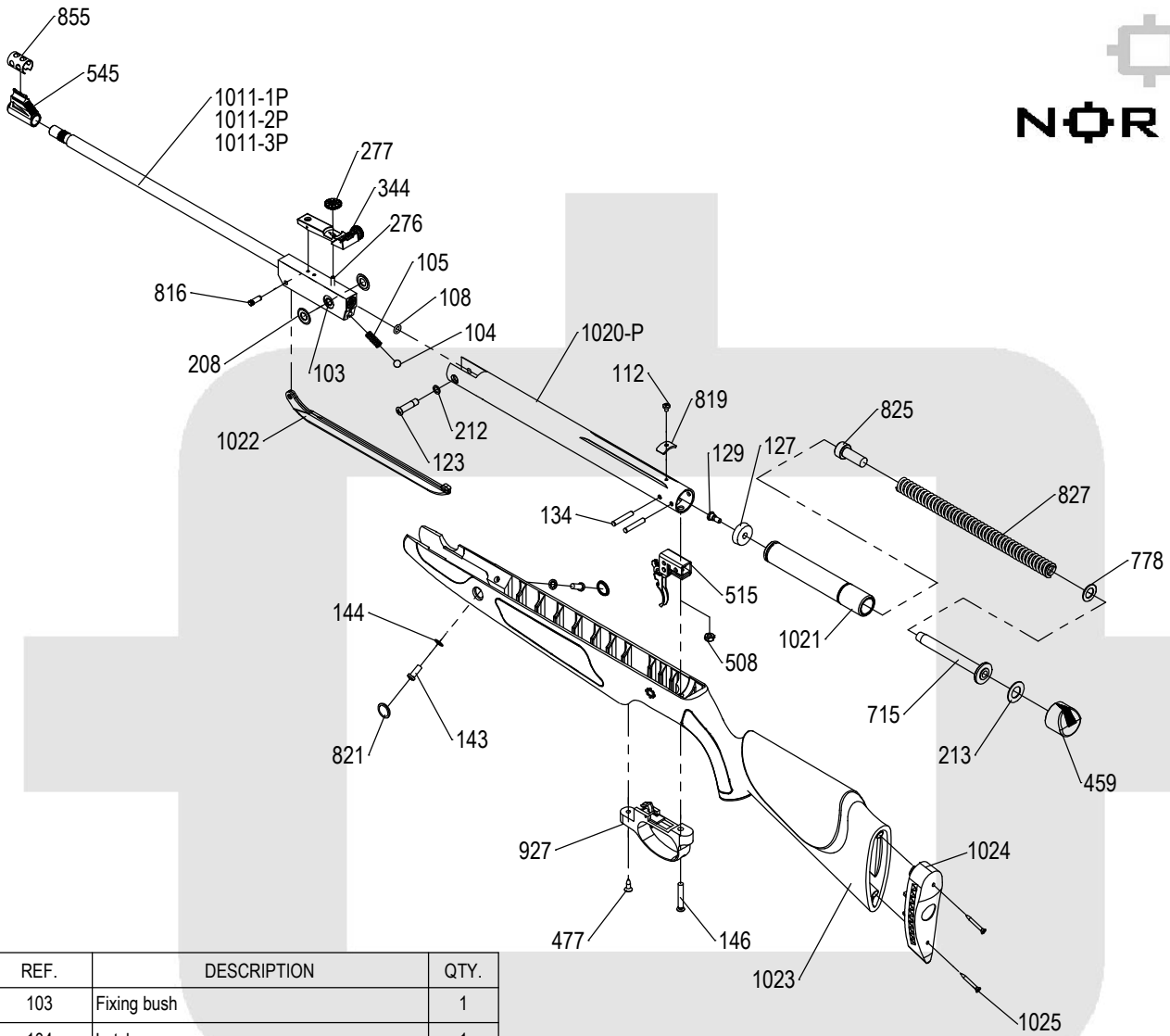

NORICA®



REF.	DESCRIPTION	QTY.
103	Fixing bush	1
104	Latch	1
105	Latch spring	1
108	O Ring	1
112	Fixing Screw	1
123	Hinge screw	1
127	Piston seal	1
129	Piston seal screw	1
134	Trigger assembly pin	2
143	Lateral screw	2
144	Lateral washer	2
146	Trigger guard screw	1
208	Hinge washer	2
212	Lock washer	1
213	Washer	1
276	Socket set screw	1
277	Rear sight adjusting nut	1
344	Rear sight assembly	1
459	Tube cap	1
477	Trigger guard lag screw	1
508	Nut	1
515	Trigger assembly	1
545	Front sight	1
715	Main spring guide	1

REF.	DESCRIPTION	QTY.
778	Washer	1
816	Lever pin	1
819	Scope stopper	1
821	Lateral cap (Black)	2
825	Spring supplement	1
827	Main spring	1
855	Front sight protector	1
927	Trigger guard + Safety	1
1011-1P	Barrel assembly Cal. 4,5 (.177)	1
1011-2P	Barrel assembly Cal. 5,5 (.22)	1
1011-3P	Barrel assembly Cal. 6,35 (.25)	1
1020-P	Cylinder assembly	1
1021	Piston	1
1022	Cocking lever	1
1023	Stock	1
1024	Buttplate	1
1025	Buttplate lag screw	2